

NOTE:

1. ALL DIMENSIONS IN MM [INCH]
2. GENERAL TOLERANCE: X.X = ±0.4  
X.XX = ±0.25
3. TERMINAL NUMBERS FOR REF ONLY
4. CONTACT MATERIAL: SILVER PLATED
5. RATING: 2A 36VDC
6. ELECTRIC LIFE: 200,000
7. INSULATION RESISTANCE: 1,000MΩ MIN @ 500VDC.
8. DIELECTRIC STRENGTH: 2,000VAC MIN. FOR 1 MINUTE
9. CONTACT RESISTANCE: 50mΩ MAX. @ 1A 12VDC
10. OPERATING TEMP.: -20°C to 70°C
11. TRAVEL: 2.0mm
12. ▲ DENOTES CRITICAL PARAMETER.
- ▲ 13. ILLUMINATION COLOR: RED
- ▲ 14. HARDWARE SUPPLIED: O-RING AND HEXNUT (NOT SHOWN)
15. ILLUMINATION VOLTAGE RATING: 1.7 - 2.5V @ 20mA
16. INGRESS PROTECTION: IP67

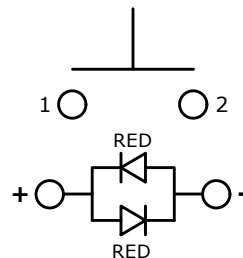

▲ SCHEMATIC  
OFF - (ON)  
( ) DENOTES MOMENTARY FUNCTION

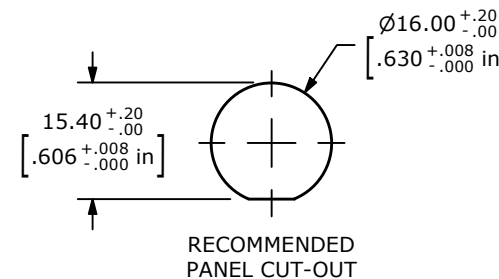

|     |        |             |         |    |
|-----|--------|-------------|---------|----|
| A   | 24330  | New Release | 5/29/20 | MW |
| REV | PCR NO | DESCRIPTION | DATE    | BY |

|                   |           |    |         |     |
|-------------------|-----------|----|---------|-----|
| TITLE PVA6FEW4S11 |           |    |         |     |
| SCALE             | DATE      | DR | DWG     | REV |
| 1:1               | 5/29/2020 | MW | T960045 | A   |

THE INFORMATION CONTAINED IN THIS DOCUMENT IS PROPRIETARY TO E-SWITCH AND IS NOT TO BE COPIED OR TRANSFERRED